

HD35 (DHD3.5) MARTILLO DE FONDO DTH

| HD35 (DHD3.5) Maartillo | Descripción del Artículo | Peso kg | Número de parte |
|-------------------------|--------------------------|---------|-----------------|
|-------------------------|--------------------------|---------|-----------------|

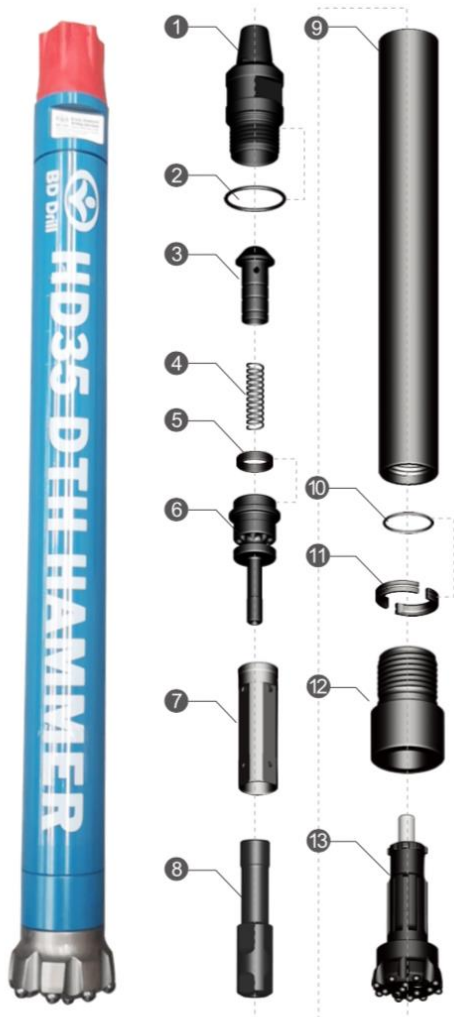

| | | | |
|----|-----------------------|------|--------------|
| 1 | Top Sub | 4.20 | HD35-TSUB |
| 2 | "O" Ring of Top Sub | 0.01 | HD35-SR-TSUB |
| 3 | Check Valve | 0.20 | HD35-CVALVE |
| 4 | Spring | 0.02 | HD35-SPRING |
| 5 | Compression Buffer | 0.02 | HD35-CBUFFER |
| 6 | Air Distributor | 1.40 | HD35-DIST |
| 7 | Internal Cylinder | 1.50 | HD35-ICYL |
| 8 | Piston | 5.60 | HD35-PISTON |
| 9 | External Cylinder | 9.90 | HD35-ECYL |
| 10 | "O" Ring of Stop Ring | 0.01 | HD35-SR-RING |
| 11 | Stop Ring | 0.15 | HD35-SRING |
| 12 | Drive Chuck | 1.90 | HD35-DCHUCK |
| 13 | Drill Bit | | HD35-90FF-TV |

Datos técnicos

| Largo(sin broca) | Peso(sin broca) | Diámetro externo | Vástago de broca | Rango de agujeros | Hilo de conexión |
|------------------|----------------------------|-----------------------------------|------------------|-------------------|------------------------------|
| 930mm | 24.4Kg | Φ82mm | DHD3.5 HD35 | Φ92- Φ105 | API 2 3/8" REG CUBEX # 21 |
| Tamaño de caja | I Tasa de impacto a 1.7Mpa | Velocidad de rotación recomendada | Consumo de aire | | |
| 1020x110x140mm | 28Hz | 25-40r/min | 150-250(PSI) | | |
| | | | 300-400(CFM) | | |